

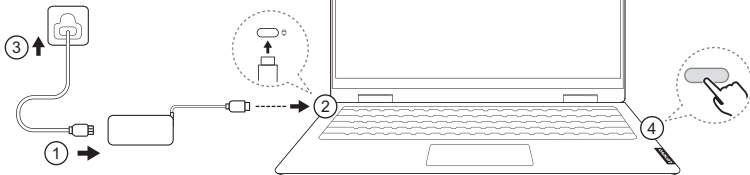



Lenovo ThinkBook 14 2-in-1 Gen 5



Get it started



 Power plugs vary by country or region. Product illustrations may not be exactly the same as the actual product.

 Asterisks ("*") are used in this publication to mark parts and features that are not available on all product models.



Overview



① **Microphones**



② **Camera shutter**

③ **Infrared LED***



Camera ④



Screen ⑤



Touchpad ⑥

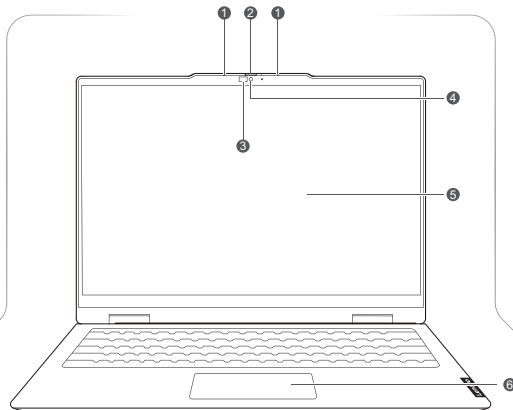

 Scan the *User Guide* QR code to learn more about the product features and the statement on USB transfer rates.



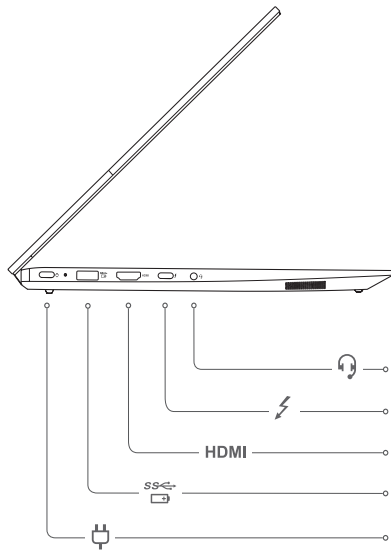

Combo audio jack



Multi-purpose USB Type-C® connector

HDMI

HDMI™ connector



USB Standard-A connector (always-on connector)

 The USB Type-C connector with an icon ⚡ is Thunderbolt™ 4 enabled. The USB Type-C connector with a plug icon  next to it also functions as the PC's power input connector.



Power button



microSD™ card slot



USB Standard-A connector



Security lock slot

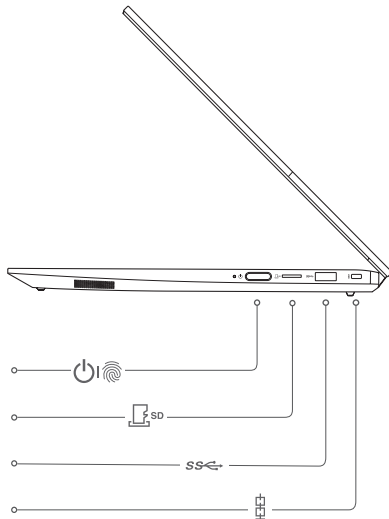

 The power button includes an embedded fingerprint sensor.

Specific absorption rate (SAR)

YOUR DEVICE MEETS INTERNATIONAL GUIDELINES FOR EXPOSURE TO RADIO WAVES.

Refer to the following for 10g SAR limit and maximum reported SAR values:

Item	Body-worn SAR	Limb SAR
10g SAR limit	2 W/kg	4 W/kg
Maximum SAR with 0 mm separation distance	1.579 W/kg	1.579 W/kg

For more information about SAR, refer to the *Safety and Warranty Guide* that came with your device.

European Union (EU) / United Kingdom (UK) — radio frequency and power

This radio equipment operates with the following frequency bands and maximum radio frequency power.

Technology	Frequency band [MHz]	Maximum transmit power
WLAN 802.11b/g/n/ax	2400 – 2483.5	< 20 dBm
WLAN 802.11a/n/ac/ax	5150 – 5725	< 23 dBm
WLAN 802.11a/n/ac/ax	5725 – 5875	< 13.98 dBm
WLAN 802.11ax	5945 – 6425	< 23 dBm
Bluetooth BR/EDR/LE	2400 – 2483.5	< 20 dBm

Note: Not all wireless bands may be enabled depending on your product configuration. Usage of this device is limited to indoor locations in the bands 5150 – 5350 MHz and 5945 – 6425 MHz.

First Edition (March 2025)
© Copyright Lenovo 2025.

Lenovo and the Lenovo logo are trademarks of Lenovo. USB Type-C is a registered trademark of USB Implementers Forum. The terms HDMI and HDMI High-Definition Multimedia Interface, and the HDMI logo are trademarks or registered trademarks of HDMI Licensing Administrator, Inc. in the United States and other countries. Thunderbolt is a trademark of Intel Corporation or its subsidiaries. microSD is a trademark of SD-3C LLC. All other trademarks are the property of their respective owners.

LIMITED AND RESTRICTED RIGHTS NOTICE:

If data or software is delivered pursuant to a General Services Administration "GSA" contract, use, reproduction, or disclosure is subject to restrictions set forth in Contract No. GS-35F-05925.

Reduce
Reuse
Recycle



For FSC Mix logo only