

# ThinkCentre M75t Gen 5

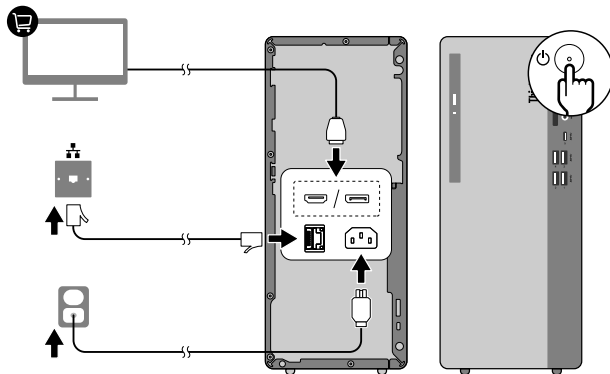

**i** Read the statement on USB transfer rate in the *User Guide*. To access the *User Guide*, see the methods mentioned in the *User Guide Access* section.

\* For selected models

**[English]**

**European Union (EU) / United Kingdom (UK) — radio frequency and power**

This radio equipment operates with the following frequency bands and maximum radio-frequency power.

Technology	Frequency band [MHz]	Maximum transmit power
WLAN 802.11b/g/n/ax	2400 - 2483.5	< 20 dBm
WLAN 802.11a/n/ac/ax	5150 - 5725	< 23 dBm
WLAN 802.11a/n/ac/ax	5725 - 5875	< 13.98 dBm
WLAN 802.11ax	5945 - 6425	< 23 dBm
Bluetooth BR/EDR/LE	2400 - 2483.5	< 20 dBm

Note: Not all wireless bands may be enabled depending on your product configuration. Usage of this device is limited to indoor locations in the bands 5150 - 5350 MHz and 5945 - 6425 MHz.



## User Guide Access

User Guide Access | User Guide Access | User Guide Access | User Guide Access | User Guide Access | User Guide Access

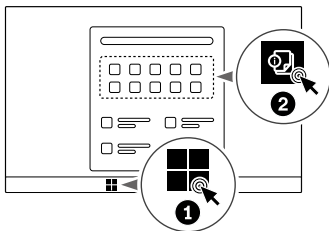

**Reduce**

**Reuse**

**Recycle**



First Edition  
(August 2024)

© Copyright Lenovo 2024.

LENOVO, LENOVO logo, ThinkCentre, and ThinkCentre logo are trademarks of Lenovo.

LIMITED AND RESTRICTED RIGHTS NOTICE: If data or software is delivered pursuant to a General Services Administration "GSA" contract, use, reproduction, or disclosure is subject to restrictions set forth in Contract No. GS-35F-05925.